

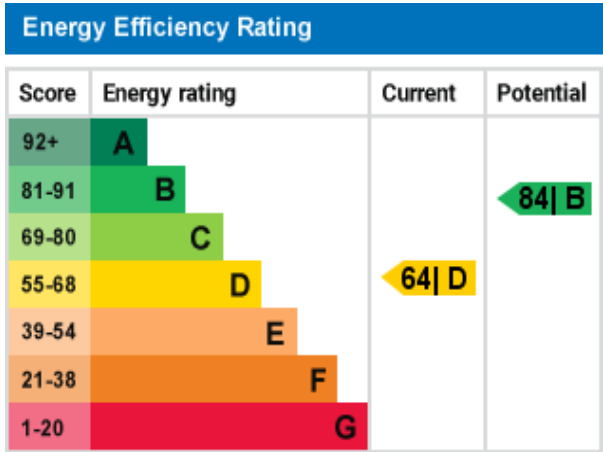

North Cray Road, Bexley, Kent, DA5 3LZ

Guide Price £425,000-£435,000

Located within the heart of Old Bexley Village, giving convenient access to popular local schools, shops restaurants, Bexley Station and all other transport links, is this beautifully presented two double bedroom period cottage. Refurbished throughout by the current vendors, this stunning home offers generous accommodation comprising of two reception rooms, luxury fitted kitchen and a ground floor / utility room. To the first floor there are two bedrooms and a luxury bathroom. Additional benefits to note include double glazing, some secondary glazing, gas central heating, integral kitchen appliances and a secluded rear garden with side access. Viewing is highly recommended.

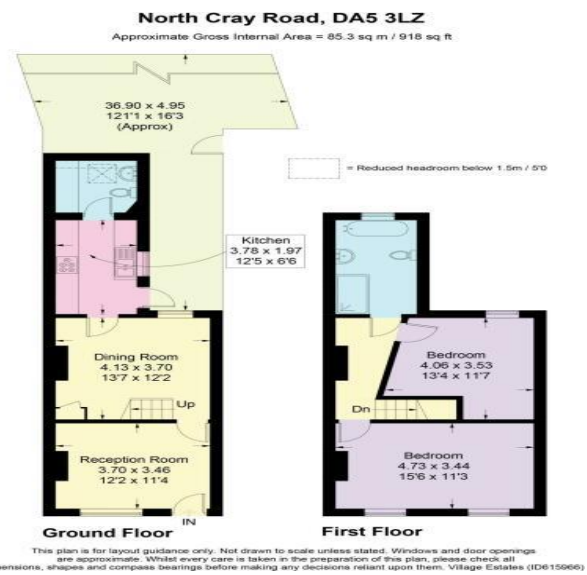

Council Tax
Band C.



